

Specifications

Eave height:
2.40m

Span width:
25.00m

Peak height:
10.45m

Ridge height:
6.40m

Bay distance:
5.00m

Roof pitch:
18°

Number of gable uprights:
4 Gable upright (per end)

Longest component:
13.25m

Minimum length:
20.00m

Maximum length:
Unlimited in 5.00m increments

Max allowed wind speed:
102 km/h (0.50kN/m²)

Main profile size:
220/100/4mm or 225/101/3.5/5.5mm (4-channel)

Eave connection type:
Aluminium Sliding

Aluminium type:
European - Hard Pressed Extruded Structural Aluminium

Connecting components:
European - hot dipped, structural grade corrosive resistant galvanised steel

Roof covering type:
Premium grade, high gloss white, PVC coated polyester fabric - UV resistant and flame retardant according to: DIN 4102 B1, M2; BS 5438/7837; USA NFPA701.

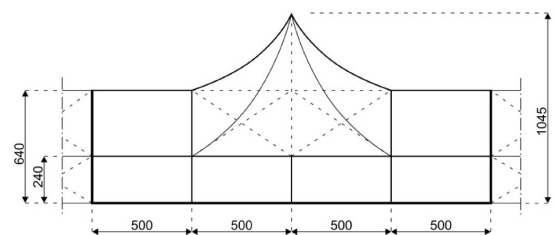
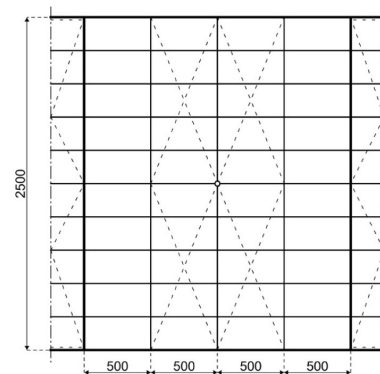
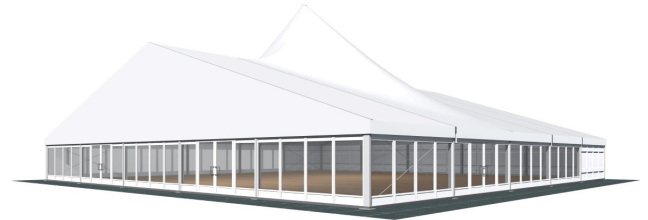

HTS tentiq disclaim any and all liability for any errors, inaccuracies or incompleteness contained in any datasheet on this website. All product, product specification and data are subject to change without notice to improve reliability, function or design or otherwise.

Accessories

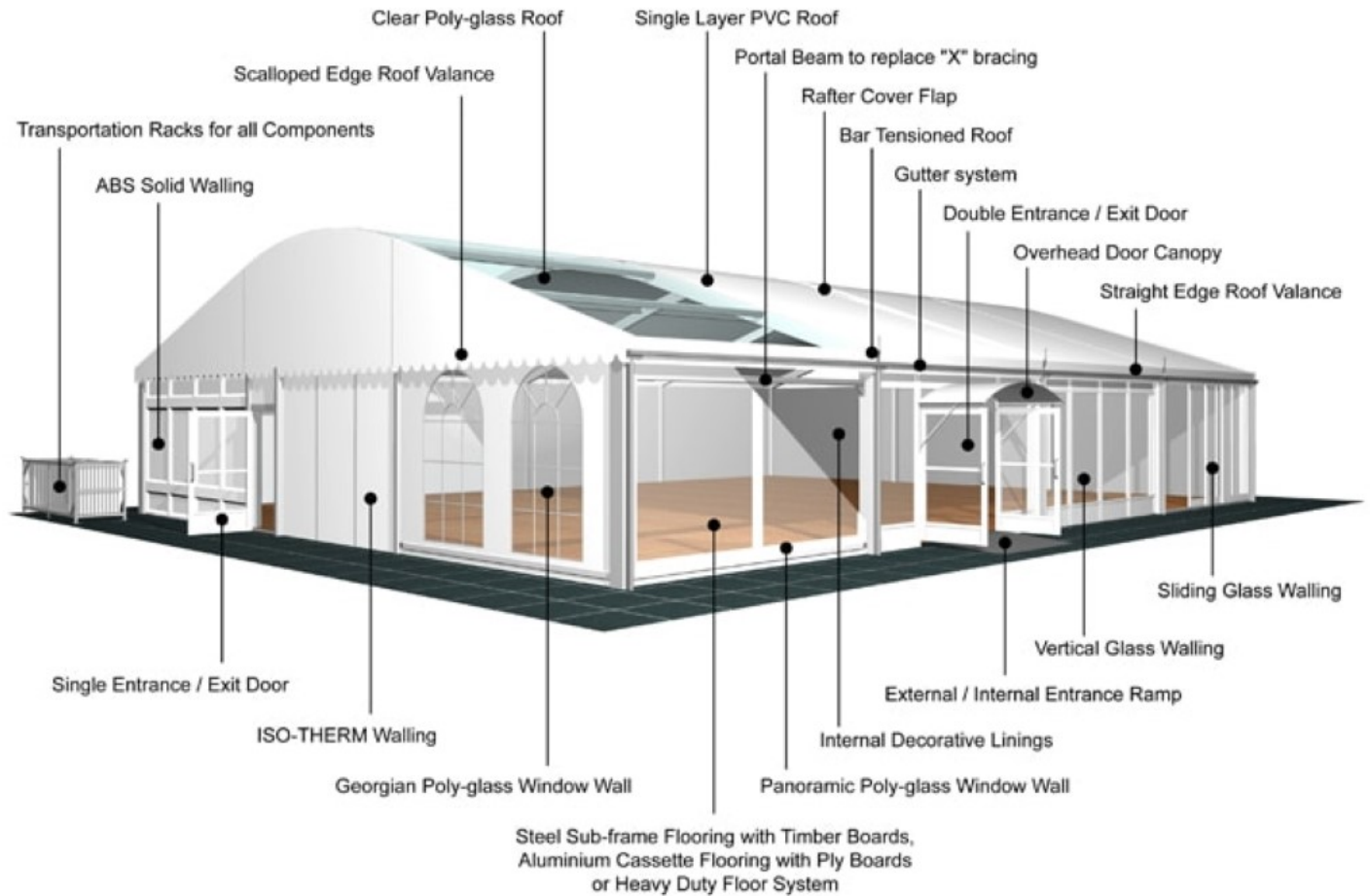

HTS tentiq disclaim any and all liability for any errors, inaccuracies or incompleteness contained in any datasheet on this website. All product, product specification and data are subject to change without notice to improve reliability, function or design or otherwise.