

## Specifications

**Eave height:**  
5.20m

**Span width:**  
30.00m

**Ridge height:**  
10.20m

**Bay distance:**  
5.00m

**Roof pitch:**  
18°

**Longest component:**  
10.80m

**Minimum length:**  
30.00m

**Maximum length:**  
Unlimited in 5.00m increments

**Snow loading:**  
Engineered to meet regional building code requirements according to BS6399 / Euro codes / IBC 2012

**Max allowed wind speed:**  
Engineered to meet regional building code requirements according to BS6399 / Euro codes / IBC 2012

**Main profile size:**  
334/122/8/4.5mm (4-channel)

**Eave connection type:**  
Internal galvanised steel insert

**Aluminium type:**  
European - Hard Pressed Extruded Structural Aluminium

**Connecting components:**  
CE Certified - hot dipped, structural grade corrosive resistant galvanised steel

**Roof covering type:**  
Highly durable industrial grade, high gloss white, PVC coated polyester fabric - UV resistant and flame retardant according to: DIN 4102 B1, M2; BS 5438/7837; USA NFPA701

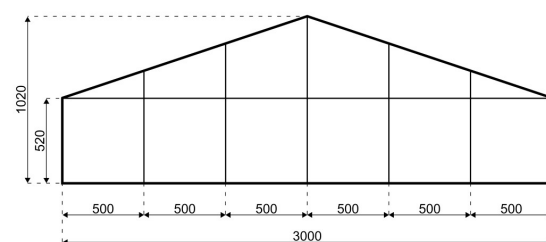
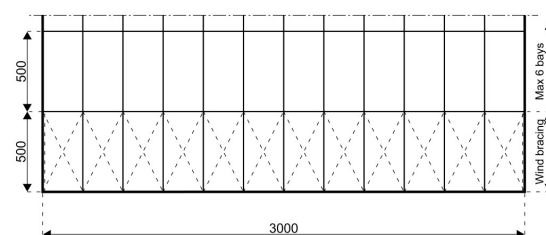
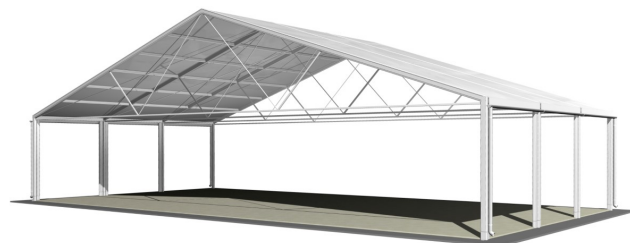

HTS tentiq disclaim any and all liability for any errors, inaccuracies or incompleteness contained in any datasheet on this website. All product, product specification and data are subject to change without notice to improve reliability, function or design or otherwise.

## Accessories

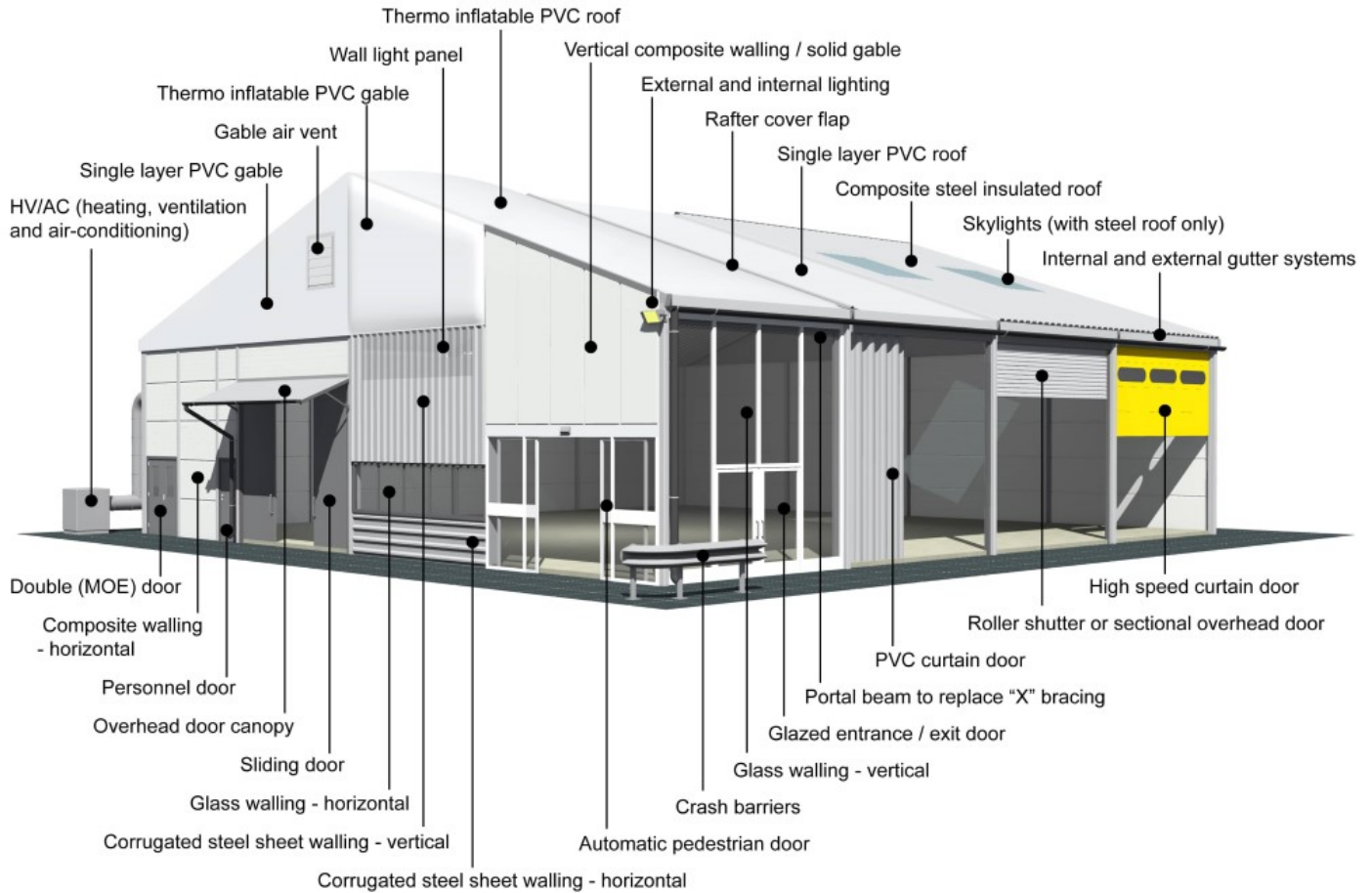

HTS tentiq disclaim any and all liability for any errors, inaccuracies or incompleteness contained in any datasheet on this website. All product, product specification and data are subject to change without notice to improve reliability, function or design or otherwise.