

Specifications

Eave height:
6.20m

Span width:
10.00m

Ridge height:
7.82m

Bay distance:
5.00m

Roof pitch:
18°

Number of gable uprights:
1 Gable upright (per end)

Longest component:
6.20m

Minimum length:
10.00m

Maximum length:
Unlimited in 5.00m increments

Snow loading:
Engineered to meet regional building code requirements according to BS6399 / Euro codes / IBC 2012

Max allowed wind speed:
Engineered to meet regional building code requirements according to BS6399 / Euro codes / IBC 2012

Main profile size:
334/122/8/4.5mm (4-channel)

Eave connection type:
Internal galvanised steel insert

Aluminium type:
European - Hard Pressed Extruded Structural Aluminium

Connecting components:
CE Certified - hot dipped, structural grade corrosive resistant galvanised steel

Roof covering type:
Highly durable industrial grade, high gloss white, PVC coated polyester fabric - UV resistant and flame retardant according to: DIN 4102 B1, M2; BS 5438/7837; USA NFPA701

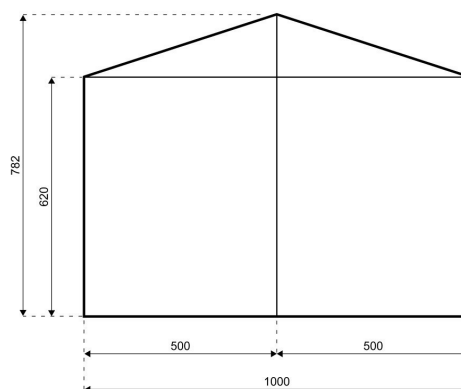
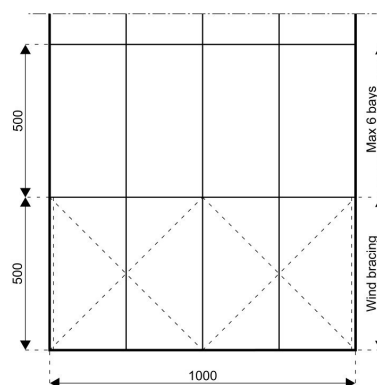

HTS tentiq disclaim any and all liability for any errors, inaccuracies or incompleteness contained in any datasheet on this website. All product, product specification and data are subject to change without notice to improve reliability, function or design or otherwise.

Accessories

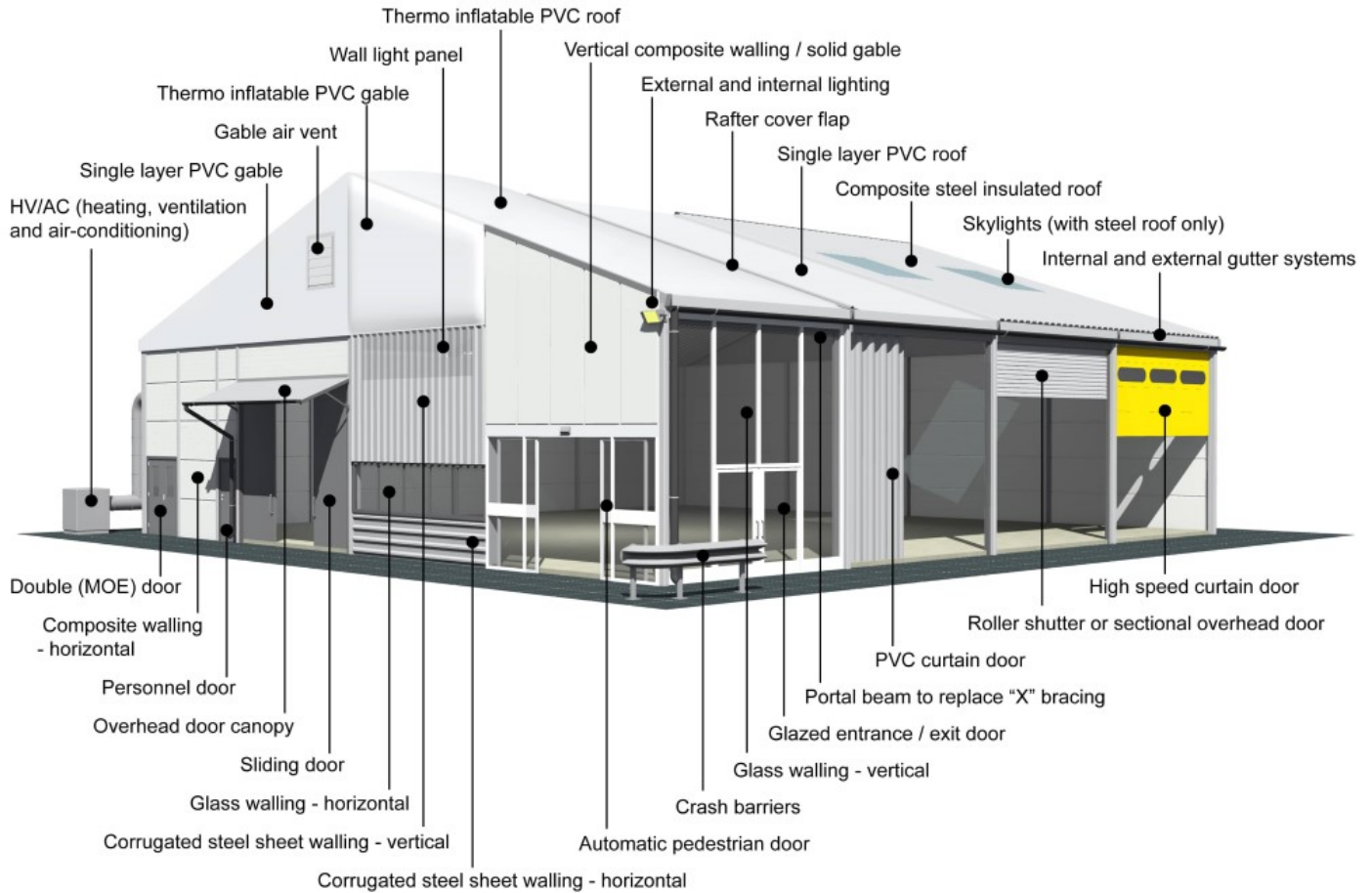

HTS tentiq disclaim any and all liability for any errors, inaccuracies or incompleteness contained in any datasheet on this website. All product, product specification and data are subject to change without notice to improve reliability, function or design or otherwise.