

## Specifications

**Eave height:**  
3.00m

**Span width:**  
20.00m

**Ridge height:**  
6.48m

**Bay distance:**  
5.00m

**Roof pitch:**  
18°

**Number of gable uprights:**  
3 Gable upright (per end)

**Longest component:**  
10.66m

**Minimum length:**  
20.00m

**Maximum length:**  
Unlimited in 5.00m increments

**Max allowed wind speed:**  
102 km/h (0.50kN/m<sup>2</sup>)

**Main profile size:**  
210/110/3mm

**Eave connection type:**  
Aluminium connection with locking pins

**Aluminium type:**  
European - Hard Pressed Extruded Structural Aluminium

**Connecting components:**  
European - hot dipped, structural grade corrosive resistant galvanised steel

**Roof covering type:**  
Premium grade, high gloss white, PVC coated polyester fabric - UV resistant and flame retardant according to: DIN 4102 B1, M2; BS 5438/7837; USA NFPA701.

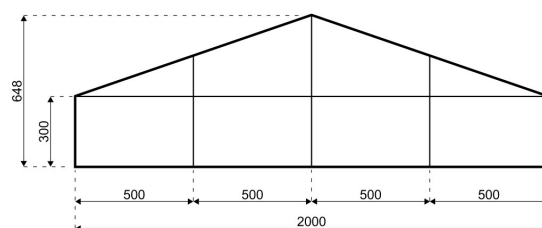
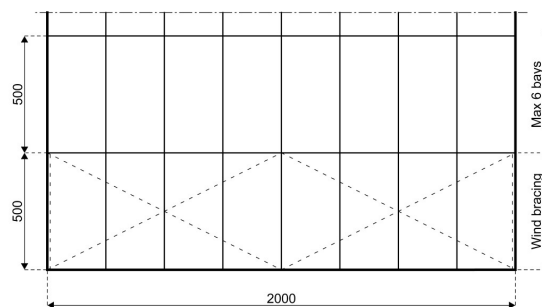
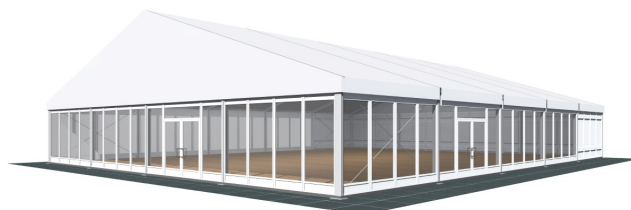

HTS tentiq disclaim any and all liability for any errors, inaccuracies or incompleteness contained in any datasheet on this website. All product, product specification and data are subject to change without notice to improve reliability, function or design or otherwise.

## Accessories

*HTS tentiq disclaim any and all liability for any errors, inaccuracies or incompleteness contained in any datasheet on this website. All product, product specification and data are subject to change without notice to improve reliability, function or design or otherwise.*

HEAD OFFICE & PRODUCTION  
HTS tentiq  
Hinter der Schlagmühle 1  
Kefenrod, D-63699  
Germany

T: +44 (0) 1276 462 600  
E: [salesuk@hts-tentiq.com](mailto:salesuk@hts-tentiq.com)  
W: [www.hts-tentiq.com](http://www.hts-tentiq.com)

Represented worldwide in:  
Australia  
Austria  
Bosnia  
Bulgaria  
Central America  
Croatia  
France  
Germany  
Great Britain  
Greece

India  
Ireland  
Italy  
Middle Asia  
Middle East  
Netherlands

North America  
Poland  
Romania  
Russia  
Scandinavia  
Singapore

Slovenia  
South Africa  
South America  
Spain  
Switzerland