

Specifications

Eave height:
3.00m

Span width:
30.00m

Ridge height:
8.12m

Bay distance:
5.00m

Roof pitch:
18°

Number of gable uprights:
5 Gable upright (per end)

Longest component:
10.57m

Minimum length:
30.00m

Maximum length:
Unlimited in 5.00m increments

Max allowed wind speed:
102 km/h (0.50kN/m²)

Main profile size:
285/110/4/5mm

Eave connection type:
Aluminium connection with locking pins

Aluminium type:
European - Hard Pressed Extruded Structural Aluminium

Connecting components:
European - hot dipped, structural grade corrosive resistant galvanised steel

Roof covering type:
Premium grade, high gloss white, PVC coated polyester fabric - UV resistant and flame retardant according to: DIN 4102 B1, M2; BS 5438/7837; USA NFPA701.

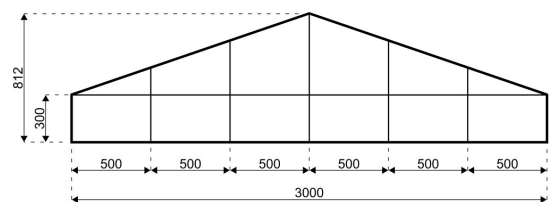
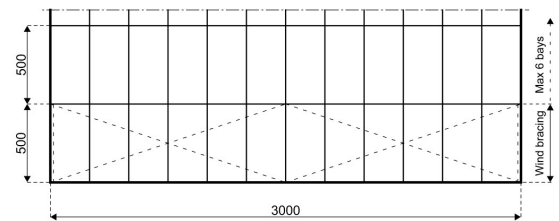
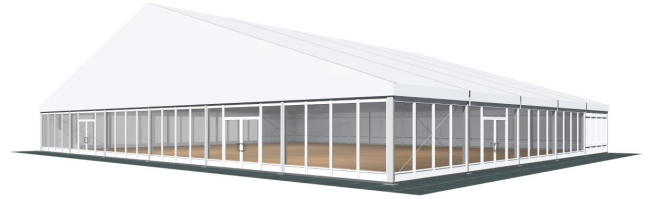

HTS tentiq disclaim any and all liability for any errors, inaccuracies or incompleteness contained in any datasheet on this website. All product, product specification and data are subject to change without notice to improve reliability, function or design or otherwise.

Accessories

HTS tentiq disclaim any and all liability for any errors, inaccuracies or incompleteness contained in any datasheet on this website. All product, product specification and data are subject to change without notice to improve reliability, function or design or otherwise.

HEAD OFFICE & PRODUCTION
HTS tentiq
Hinter der Schlagmühle 1
Kefenrod, D-63699
Germany

T: +44 (0) 1276 462 600
E: salesuk@hts-tentiq.com
W: www.hts-tentiq.com

Represented worldwide in:
Australia
Austria
Bosnia
Bulgaria
Central America
Croatia
France
Germany
Great Britain
Greece

India
Ireland
Italy
Middle Asia
Middle East
Netherlands

North America
Poland
Romania
Russia
Scandinavia
Singapore

Slovenia
South Africa
South America
Spain
Switzerland